

LOS ANGELES COUNTY
DEPARTMENT OF PUBLIC WORKS
BENCH MARK LIST



HAWTHORNE QUAD
TORRANCE QUAD

1990 ADJUSTMENT
NGVD 29 DATUM

PREFACE 1990

The Department of Public Works level net is composed of more than 1,700 miles of levels supporting in excess of 9,000 bench marks. In 1990, a major readjustment of the Baseline and nets was undertaken. To emphasize the complete break with previous elevations, the CY, CG & CL series bench marks have been relabeled DY, DG, & DL, respectively.

To facilitate the adjustment, indexing, and distribution of adjusted values of the net, the County territory is divided into 33 quads or areas. For identification purposes each quad is given a name, viz., "Rosemead," "La Mirada," "Santa Fe", etc. When bench marks and elevations in these nets are used, the name of the quad and the date of the adjustment must be included in the bench mark description, e.g.,

DY 9701 - RDBM TAG IN CB 5FT S/O BCR @ SE COR BOLSA ST & DOMINGUEZ ST
63FT S & 20FT E/O C/L INT
(GARDENA - 1990) ELEV. 16.704

Experience indicates that this general adjustment will, for the most part, remain sound for the next 10 years. Updating constrained adjustments will be made in 5 years. It is expected that these updating adjustments will be in the nature of a few hundredths of a foot. When a quad is readjusted, new elevation lists will be published and the date of the readjustment will be noted in the bench mark description. Two bench marks with different adjustment dates will not normally agree with each other.

The basic accuracy of the net is reflected by an indicated field probable error of plus or minus 0.012 foot per mile of leveling as determined from over 600 conditions of closure. However, many years experience in vertical control in the greater Los Angeles basin and Antelope Valley indicate that because of varying degrees of subsidence and heaving, the true datum is recovered only by obtaining substantial agreement of a number of bench marks.

The users of this net are invited to assist in its maintenance by notifying this Department of cases of obliteration, apparent mistakes in descriptions or elevations, and proven disturbance of bench marks.

DATUM: U.S. Coast and Geodetic Survey Sea Level Datum
of 1929, through the medium of the Los Angeles
County Engineer Precise Level Net.

HAWTHORNE

QUAD

TORRANCE QUAD 2-20-91

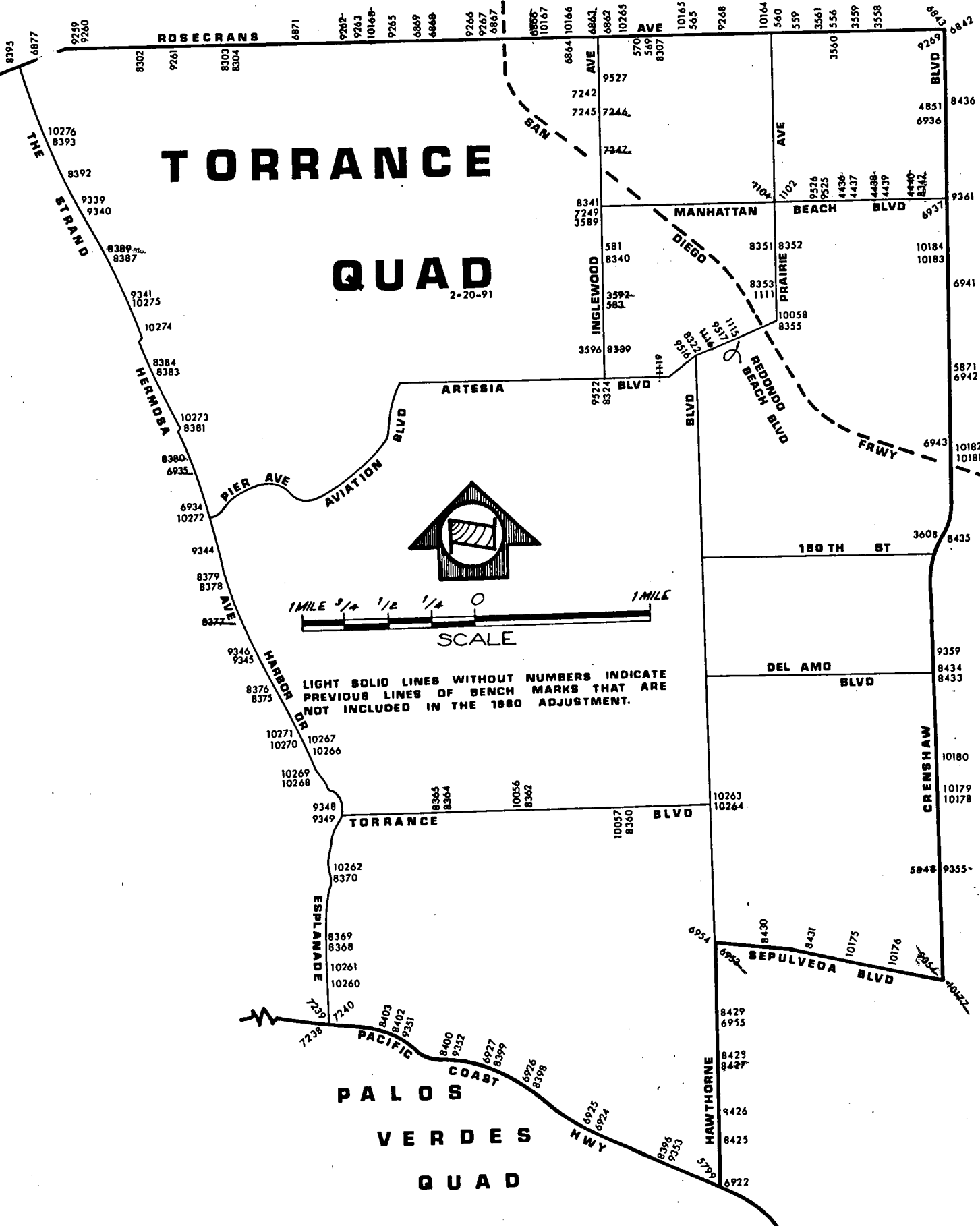

GARDENA QUAD

LIGHT SOLID LINES WITHOUT NUMBERS INDICATE PREVIOUS LINES OF BENCH MARKS THAT ARE NOT INCLUDED IN THE 1980 ADJUSTMENT.

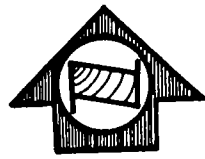
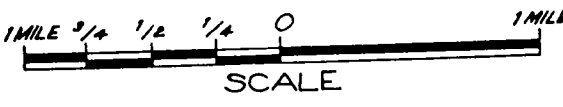

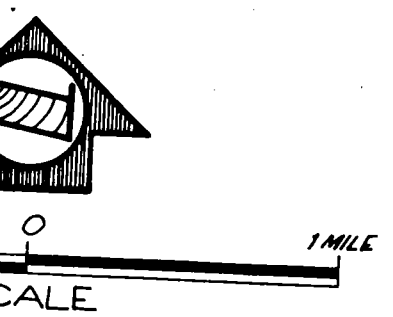
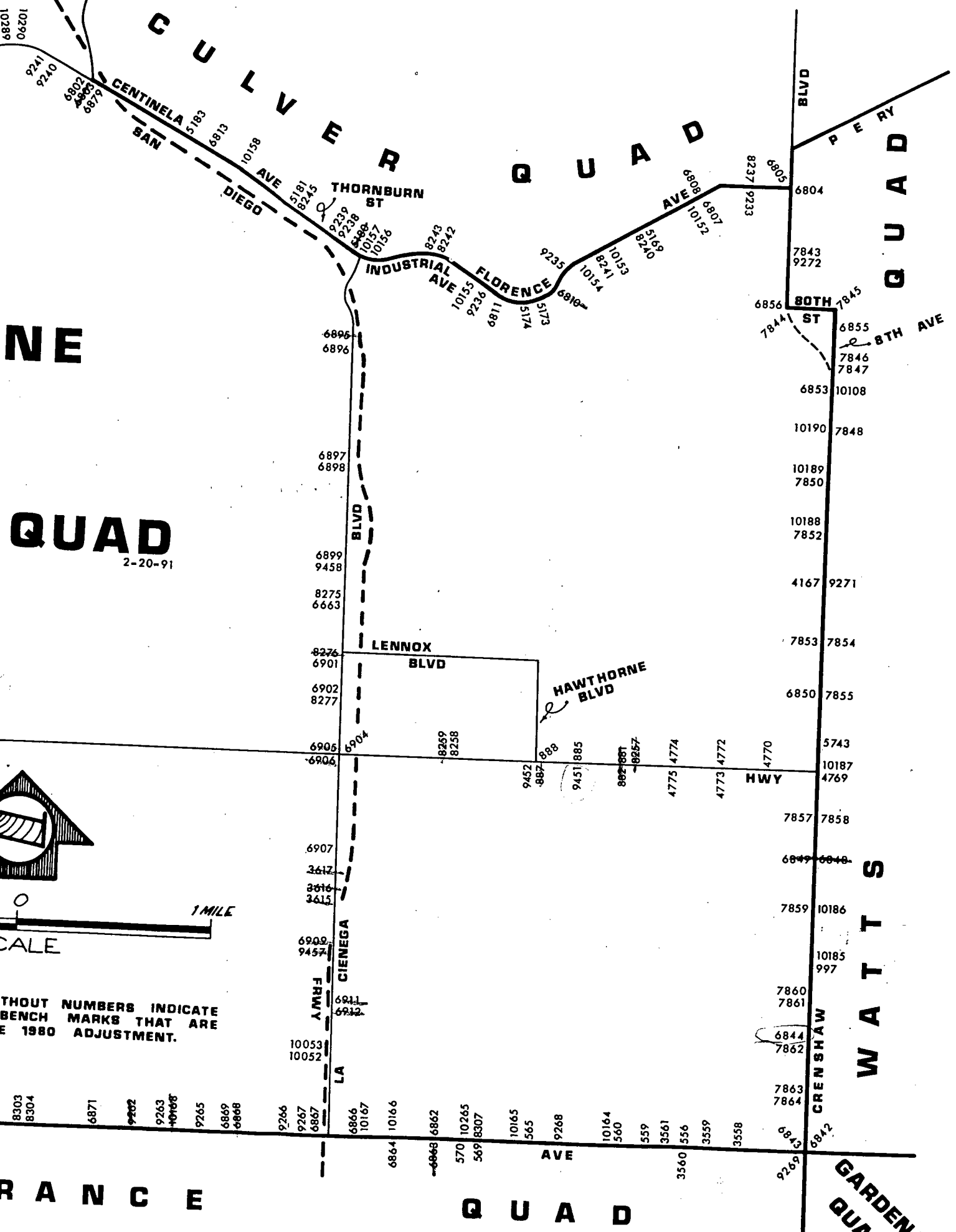

THOUT NUMBERS INDICATE BENCH MARKS THAT ARE E 1980 ADJUSTMENT.

RANCE QUAD

GARDEN QUAD

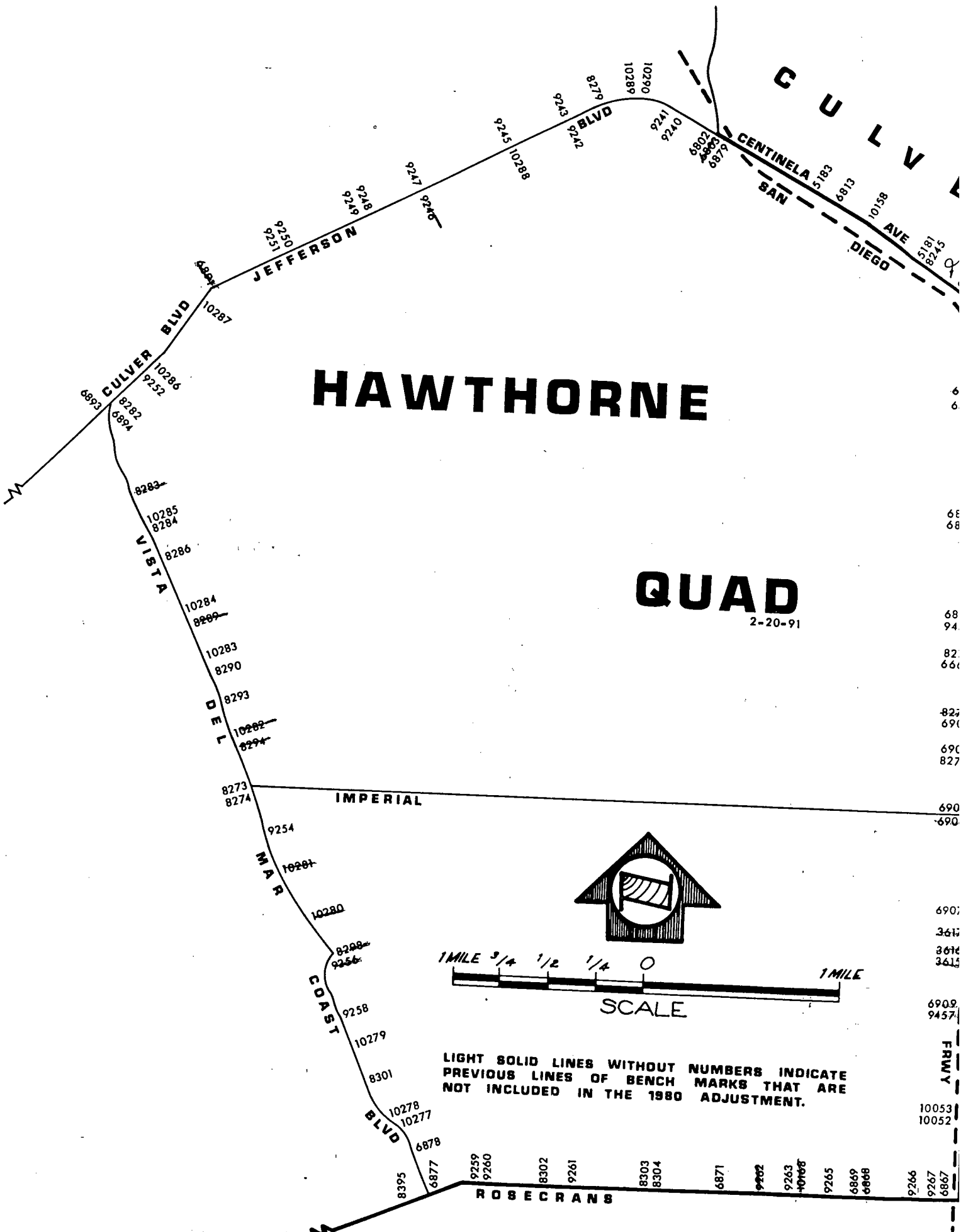

HAWTHORNE

QUAD

2-20-91



LIGHT SOLID LINES WITHOUT NUMBERS INDICATE PREVIOUS LINES OF BENCH MARKS THAT ARE NOT INCLUDED IN THE 1980 ADJUSTMENT.

6
6
68
68
68
94
82
66
82
69
69
827
690
690
690
361
361
361
690
945
FRWY
10053
10052

TORRANCE

QUAD-YEAR	ELEV	DESCRIPTION (INCLUDE QUAD AND YEAR IN DESCRIPTION)	BM NUMBER
BASELINE (1990)	51.229	RDBM TAG W CB 1FT N/O BCR @ NW COR ROSECRANS AVE & KORNBLUM AVE 68FT N & 18FT W C/L INT W C/L INT	DY 556
BASELINE (1990)	53.886	RDBM TAG E CB 1FT N/O BCR NE COR ROSECRANS AVE & CORDARY AVE 71FT N & 18FT E/O C/L INT	DY 559
BASELINE (1990)	53.369	CS BR CAP MON IN WELL INT ROSECRANS AVE & PRAIRIE AVE TRI STA MKD (INGLEWOOD G-12-B) 1941 RE 2177	DY 560
BASELINE (1990)	61.859	CS BR CAP MON IN WELL C/L INT HAWTHORNE BLVD (E BARREL) & ROSECRANS AVE	DY 565
BASELINE (1990)	72.663	CS MON IN WELL 4FT W/O C/L MANSEL AVE 2FT S C/L ROSECRANS AVE SUR CONTROL SYSTEM INGLEWOOD MKD (F-12-A)	DY 569
BASELINE (1990)	70.318	L&T CONC PVMT 9FT S/O C/L ROSECRANS AVE 10FT W/O FIRMONA AVE (TO THE SOUTH)	DY 570
TORRANCE (1990)	67.649	CS BR CAP MON IN WELL C/L INT 162ND ST & INGLEWOOD AVE MKD (RE 329)	DY 581
TORRANCE (1990)	88.231	L & T IN W CB @ BCR NW COR INGLEWOOD AVE & ROBINSON ST 19FT W & 60FT N C/L INT TO W	DY 583
HAWTHRNE (1990)	68.615	CUT SPK CONC PVMT 14FT N C/L IMPERIAL HWY 70FT E C/L PRAIRIE AVE	DY 881
HAWTHRNE (1990)	68.695	CUT SPK CONC PAVING 14FT S C/L IMPERIAL HWY 70FT E C/L PRAIRIE AVE	DY 882
HAWTHRNE (1990)	68.783	L&T N CB IMPERIAL HWY 40FT N & 50FT E C/L PROD CEDAR AVE	DY 885
HAWTHRNE (1990)	69.147	ST HWY MON IN WELL 12IN DN @ OR NR C/L INT IMPERIAL HWY & HAWTHORNE BLVD	DY 887
HAWTHRNE (1990)	69.393	RAMSET E CB HAWTHORNE BLVD 48FT N BCR @ NE COR IMPERIAL HWY 118FT N & 60FT E C/L INT	DY 888
BASELINE (1990)	51.156	LAFC MON 12IN DN 50FT S C/L EL SEGUNDO BLVD & 175FT E C/L CRENSHAW BLVD ON W P/L DOMINGUEZ LAFC CHANNEL MKD (1959-27 75A CO ENGR)	DY 997
TORRANCE (1990)	48.082	L&SPK 6FT E BCR SERVICE RD ISLAND @ NE COR PRAIRIE AVE & MANHATTAN BEACH BLVD 78FT E & 38FT N C/L INT MKD (KV 39)	DY 1102
TORRANCE (1990)	48.573	L&SPK @ NW COR PRAIRIE AVE & MANHATTAN BEACH BLVD 51FT N/O BCR 128FT N & 40FT W/O C/L INT MKD (SDI)	DY 1104

QUAD-YEAR	ELEV	DESCRIPTION (INCLUDE QUAD AND YEAR IN DESCRIPTION)	BM NUMBER
TORRANCE (1990)	50.609	RD BM TAG E CB PRAIRIE AVE 42FT E C/L & 40FT SO C/L PROD 166TH ST	DY 1111
TORRANCE (1990)	73.448	L&T E ECR @ NE COR FREEMAN AVE & REDONDO BEACH BLVD 30FT N & 70FT E C/L INT	DY 1115
TORRANCE (1990)	84.816	L&T NR CTR CB RET @ NE COR ALLEY & REDONDO BEACH BLVD 200FT E HAWTHORNE BLVD	DY 1116
TORRANCE (1990)	91.908	RDBM TAG IN S CB 2FT E/O ANG PT IN CB 36FT S & 130FT E/O C/L INT ARTESIA BLVD & KINGSDALE AVE	DY 1119
BASELINE (1990)	49.654	RDBM TAG IN E CB 1FT N/O BCR @ NE COR ROSECRANS AVE & CERISE AVE 67FT N & 18FT E/O C/L INT	DY 3558
BASELINE (1990)	50.033	LACS BM MON IN WELL 1FT W/O CB IN NW COR ROSECRANS AVE & YUKON AVE 72FT N & 19FT W C/L INT MKD (21-13A 1960 RE 5869)	DY 3559
BASELINE (1990)	50.936	L&T 1FT E BCR @ SE COR KORNBLUM AVE & ROSECRANS AVE 44FT E & 38FT S/O C/L INT	DY 3560
BASELINE (1990)	52.147	RDBM TAG E CB 1FT N/O BCR @ NE COR ROSECRANS AVE & DOTY AVE 66FT N & 18FT E C/L INT	DY 3561
TORRANCE (1990)	83.966	S & L IN W CB 38FT S & 19FT W C/L INT INGLEWOOD AVE & 165TH ST	DY 3592
TORRANCE (1990)	100.248	L&SPK W SIDE CONC STEP TO HSE NO 4749 172ND ST 38FT N/O C/L & 51FT E/O C/L INGLEWOOD AVE & 172ND ST	DY 3596
BASELINE (1990)	56.032	L&SPK @ SW COR CRENSHAW BLVD & 189TH ST 60FT S & 14FT W C/L INT W SERVICE RD 18FT S/O BCR MKD (BM 22-7B)	DY 3608
HAWTHRNE (1990)	87.718	RAM SET CTR OF CB RET @ SW COR W 124TH ST & LA CIENEGA BLVD 26FT S & 52FT W/O C/L INT	DY 3615
HAWTHRNE (1990)	87.228	L&BN 2FT S BCR @ SW COR W 123RD ST & LA CIENEGA BLVD 58FT S & 36FT W/O C/L INT	DY 3616
HAWTHRNE (1990)	86.196	RAM SET 5FT E BCR @ SE COR W 121ST ST & LA CIENEGA BLVD	DY 3617
BASELINE (1990)	167.204	LACS BM MON IN WELL 2FT BK OF CB & APPROX CTR OF SW CB RET CRENSHAW BLVD & CENTURY BLVD 50FT S & 47FT W/O C/L INT MKD (BM 27-68 1953 RE 63)	DY 4167

QUAD-YEAR	ELEV	DESCRIPTION (INCLUDE QUAD AND YEAR IN DESCRIPTION)	BM NUMBER
TORRANCE (1990)	43.809	L & BN IN CTR CB RET @ NW COR MANHATTEN BEACH BLVD & CRANBROOK AVE SER RD 87FT N & 28FT W C/L INT	DY 4436
TORRANCE (1990)	45.259	RDBM TAG NR S END OF RET WALL 82FT N C/L MANHATTAN BEACH BLVD & 135FT E C/L CRANBROOK AVE	DY 4437
TORRANCE (1990)	45.297	L&BN S CB MANHATTAN BEACH BLVD 20FT W C/L CERISE AVE PROD & 38FT S C/L MANHATTAN BEACH BLVD MKD (BM)	DY 4438
TORRANCE (1990)	44.911	L&BN 1FT W BCR @ NW COR MANHATTAN BEACH BLVD & CERISE AVE 38FT N & 58FT W C/L INT	DY 4439
TORRANCE (1990)	47.080	L&BN NR CTR CB RET @ NE COR MANHATTAN BEACH BLVD & LEMOLI AVE 53FT N & 27FT E C/L INT	DY 4440
BASELINE (1990)	76.482	FLT HD SPK S CB IMPERIAL HWY 10FT W/O BCR @ SW COR CRENSHAW BLVD 38FT S & 85FT W C/L INT	DY 4769
HAWTHRNE (1990)	67.478	L&T S CB IMPERIAL HWY C/L PROD LEMOLI AVE 38FT S C/L IMPERIAL HWY	DY 4770
HAWTHRNE (1990)	66.872	L & T N DEPRESSED CB IMPERIAL HWY 22FT W BCR @ NW COR YUKON AVE 40FT N & 67FT W C/L INT	DY 4772
HAWTHRNE (1990)	67.681	FLT HD SPK S CB IMPERIAL HWY @ BCR E END C B @ SW COR YUKON AVE 38FT S & 40FT W C/L INT	DY 4773
HAWTHRNE (1990)	67.529	L&RD HD SPK N CB IMPERIAL HWY 42FT W BCR @ NW COR DOTY AVE 40FT N & 68FT W C/L INT	DY 4774
HAWTHRNE (1990)	67.507	FL HD SPK 5FT W BCR @ SW COR DOTY AVE & IMPERIAL HWY 40FT S & 33FT W C/L INT	DY 4775
BASELINE (1990)	50.541	L&ROUND HD SPK 6FT N BCR @ NW COR COMPTON BLVD & CRENSHAW BLVD 60FT N & 38FT W C/L INT MKD (W7)	DY 4851
BASELINE (1990)	165.195	USC&GS DISC LIN UP 7FT N OF N CB & 62FT N C/L FLORENCE AVE & 2FT E C/L PROD PRAIRIE AVE MKD (E 416 1935)	DY 5169
BASELINE (1990)	130.069	USC&GS MON 3IN UP 60FT NLY & 54FT WLY C/L INT FLORENCE AVE & LA BREA AVE (MKD D 417 1935)	DY 5173
BASELINE (1990)	128.669	USC&GS DISC 2IN UP 4FT N OF N CB & 34FT N C/L FLORENCE AVE & 200FT W C/L LA BREA AVE & 34FT SE C/L SFRR TRACKS MKD (E 417 1935)	DY 5174
BASELINE (1990)	73.509	LACE 3/4IN HEX BAR IN WELL THORNBURN ST @ PI 477FT W C/L LA CIENEGA BLVD	DY 5180

QUAD-YEAR	ELEV	DESCRIPTION (INCLUDE QUAD AND YEAR IN DESCRIPTION)	BM NUMBER
BASELINE (1990)	83.774	LACE 3/4IN HEX BAR IN WELL @ C/L INT LA TIJERA BLVD & THORNBURN ST (TO THE E)	DY 5181
BASELINE (1990)	48.947	LACE 3/4IN HEX BAR IN WELL 9FT SW C/L CENTINELA AVE 0.45MI SE SEPULVEDA BLVD @ TOP OF A HILL	DY 5183
BASELINE (1990)	79.018	LACS BM MON IN WELL IN PKWY @ N-W COR CRENSHAW BLVD & 113TH ST 26FT N & 45FT W/O C/L INT MKD (BM 27-70A 1960 RE5869)	DY 5743
BASELINE (1990)	94.847	CS BR CAP MON IN WELL @ C/L INT PACIFIC COAST HWY & HAWTHORNE BL MKD (TOR K-12 1942 RE 2177)	DY 5799
BASELINE (1990)	85.944	BT SPK W CB 8FT S BCR @ SW COR CARSON ST & CRENSHAW BLVD 40FT W & 73FT S/O C/L INT	DY 5848
BASELINE (1990)	53.595	LACE BR CAP MON IN WELL @ C/L INT ARTESIA BLVD & CRENSHAW BLVD MKD (TORRANCE M-4)	DY 5871
HAWTHRNE (1990)	82.549	LA CITY HEX BAR MON IN WELL 16IN DN @ C/L INT LA CIENEGA BLVD & 104TH ST	DY 6663
BASELINE (1990)	28.024	USC&GS BR DISC NWLY COR CONC BR @ SW COR SEPULVEDA BLVD & CENTINELA AVE 75FT S & 50FT W C/L INT MKD (M 776 RESET 1962)	DY 6802
BASELINE (1990)	28.444	CS MON FL NELY COR CONC BR 50FT ELY C/L SEPUL- VEDA BLVD 165FT SLY C/L CENTINELA AVE MKD (BM 28-6B)	DY 6803
BASELINE (1990)	159.226	LACE HEX BAR MON IN WELL @ C/L INT CRENSHAW BLVD & FLORENCE AVE (26-62 CO ENGR)	DY 6804
BASELINE (1990)	158.278	WIRE SPK W CB 5FT N BCR @ NW COR CRENSHAW BLVD & FLORENCE AVE 60FT N & 38FT W C/L INT	DY 6805
BASELINE (1990)	177.965	USC&GS MON 9IN UP 325FT ELY & 43FT NLY C/L INT FLORENCE AVE & REDONDO BLVD 15FT SLY SFRR TRACK MKD (S 415-1935)	DY 6807
BASELINE (1990)	179.045	USC&GS MON VERTICALLY IN SIGNAL BOX NELY COR FLORENCE AVE & REDONDO BLVD 35FT NLY & 100FT ELY C/L INT MKD (E 973 1964)	DY 6808
BASELINE (1990)	130.234	USC&GS MON 3IN UP NE COR LA BREA AVE & FLORENCE AVE 150FT E & 75FT N C/L INT 6FT NLY AT&SF RR TRACK MKD (S 978 1964)	DY 6810
BASELINE (1990)	124.340	USC&GS MON 6IN UP 350FT W LA BREA AVE & 12FT N OF N CB FLORENCE AVE MKD (Z 978 1964) SURVEY MARKER POST 3FT UP 2FT W	DY 6811

QUAD-YEAR	ELEV	DESCRIPTION (INCLUDE QUAD AND YEAR IN DESCRIPTION)	BM NUMBER
BASELINE (1990)	45.042	LACE HEX BAR IN WELL 18IN DN 21FT W OF PI OF CENTINELA AVE 0.65MI SE SEPULVEDA BLVD 338FT SE C/L GREEN VALLEY CIRCLE	DY 6813
HAWTHRNE (1990)	50.024	LACS BM MON FL IN F C WALL 6FT N/O CB E SIDE CHANNEL 46FT N & 191FT E/O C/L INT ROSECRANS AVE & CRENSHAW BLVD MKD (21-11A 1964 RE 5869)	DY 6842
BASELINE (1990)	49.750	L&BN E CB 1FT N BCR @ NE COR CRENSHAW BL & ROSECRANS AVE 38FT E & 76FT N/O C/L INT	DY 6843
BASELINE (1990)	45.832	LACS BM MON IN WELL 62FT W/O C/L CRENSHAW BLVD & 6FT S C/L PROD 134TH ST MKD (BM 27-76 A 1960 RE 5869)	DY 6844
BASELINE (1990)	57.586	L AFC BR CAP MON SW COR C B ON NE COR CRENSHAW BLVD & DOMINGUEZ CHANNEL 39FT E/O C/L & 143FT N/O INT 120TH ST MKD BM (114 51 1948)	DY 6848
BASELINE (1990)	57.574	L&BN W CB 98FT N/O BCR NW COR CRENSHAW BLVD & 120TH ST 160FT N & 38FT W/O C/L INT 1FT S/O N END OF CB	DY 6849
BASELINE (1990)	90.954	LACS BM MON IN WELL ON SW COR CRENSHAW BLVD & 109TH ST (TO THE WEST) 19FT S & 70FT W C/L INT MKD (BM 27-69A 1960)	DY 6850
BASELINE (1990)	214.213	LACS BM MON IN WELL 1FT BK OF CB FACE @ SW COR CRENSHAW BLVD & MANCHESTER BLVD 104FT S & 40FT W C/L INT MKD (BM 27-66 1953)	DY 6853
BASELINE (1990)	225.028	LACE HEX BAR MON IN WELL @ C/L INT 81ST E & 8TH AVE (27-65 CO ENGR-CLA 18-10730)	DY 6855
BASELINE (1990)	242.662	LACE BM MON FL IN CONC 3FT W/O CB S-W COR CRENSHAW BLVD & 80TH ST 38FT W & 45FT S/O C/L INT MKD (24320 FT 13-C 27-64 CO ENGR CLA 18- 10770)	DY 6856
BASELINE (1990)	70.799	L&BN E CB 6FT N BCR @ NE COR ROSECRANS AVE & INGLEWOOD AVE 82FT N & 30FT E/O C/L INT (21-17C)	DY 6862
BASELINE (1990)	69.699	CS MON IN WELL 10IN DN @ NW COR ROSECRANS AVE & INGLEWOOD AVE 100FT N & 32FT W/O C/L INT MKD (BM 21-17A)	DY 6863
BASELINE (1990)	71.884	RD MON IN WELL 8IN DN @ C/L INT ROSECRANS AVE & SHOUP AVE MKD (RD 1959)	DY 6864
BASELINE (1990)	73.422	L&T S CB 12FT E BCR @ SW COR ROSECRANS AVE & OCEAN GATE AVE 58FT S & 53FT W/O C/L INT	DY 6866

QUAD-YEAR	ELEV	DESCRIPTION (INCLUDE QUAD AND YEAR IN DESCRIPTION)	BM NUMBER
BASELINE (1990)	81.980	RD MON IN WELL 9IN DN @ C/L INT ROSECRANS AVE & HINDRY AVE MKD (RD 1959)	DY 6867
BASELINE (1990)	76.870	RD TAG S CB 1FT E BCR @ SW COR ROSECRANS AVE & AVIATION BLVD 40FT S & 74FT W C/L INT	DY 6868
BASELINE (1990)	77.727	CS MON VERTICALLY IN NLY ABUT RR BR OVER ROSECRANS AVE & AVIATION BLVD 46FT NLY & 64FT WLY C/L INT MKD (BM 21-19A 1964)	DY 6869
BASELINE (1990)	114.352	CS MON IN CONC 18IN BELOW TRACKS 3FT W/OC/L SANTA FE RR 50FT N & 50FT W/O APPROX C/L INT ROSECRANS AVE & VILLAGE DR MKD (ING A-12A RM 3 1960)	DY 6871
BASELINE (1990)	27.409	USC&GS MON IN SECOND STEP FROM BOTTOM LEADING TO BEACH AT FOOT OF ROSECRANS AVE 18FT S/O C/L PROD & 26FT W/O C/L THE STRAND MKD Y-614 1941 (21-24 CO ENG)	DY 6877
HAWTHRNE (1990)	23.676	USC&GS MON IN NEXT TO TOP STEP OF STEPS LEADING TO BEACH @ 43RD ST & THE STRAND 78FT W/O C/L & 12FT N/O C/L PROD 43RD ST 1FT N/O S END OF STEPS MKD V 767 1945 (27-1 CO ENG)	DY 6878
BASELINE (1990)	26.042	LACE HEX ROD IN WELL 10IN DN @ C/L INT SEPULVEDA BLVD & CENTINELA AVE	DY 6879
HAWTHRNE (1990)	10.172	USC&GS MON 4FT UP TOP CONC WL OF S C GAS CO MOTOR PIT DEL RAY NO 11 IN VEE OF JEFFERSON BLVD & CULVER BLVD MKD (S 977 1964)	DY 6891
HAWTHRNE (1990)	18.965	USC&GS MON VERTICALLY IN BLDG 60FT SLY OF SLY CB CULVER BLVD 15FT NE OF NE CB VISTA DEL MAR MKD (P-50 1925)	DY 6893
HAWTHRNE (1990)	10.858	LACE MON FL IN WK 13FT WLY OF WLY CB CULVER PL 5FT NLY OF N CB CULVER BLVD (FT OF THE SHACK RESTAURANT--MKD 26 M 11.65)	DY 6894
HAWTHRNE (1990)	99.638	SQ SPK N CB 12FT W BCR @ NW COR MANCHESTER BLVD & LA CIENEGA BLVD 38FT N & 68FT W C/L INT	DY 6895
HAWTHRNE (1990)	99.436	L&BN W CB 1FT S BCR @ SW COR MANCHESTER BLVD & LA CIENEGA BLVD 55FT S & 38FT W C/L INT MKD (BM)	DY 6896
HAWTHRNE (1990)	94.989	BT SPK N CB @ W END FRWY BR @ NE COR ARBOR VITAE ST & LA CIENEGA BLVD 35FT N & 36FT E C/L INT	DY 6897

QUAD-YEAR	ELEV	DESCRIPTION (INCLUDE QUAD AND YEAR IN DESCRIPTION)	BM NUMBER
HAWTHRNE (1990)	94.860	L&BR W CB 6FT N BCR @ SW COR LA CIENEGA BLVD & ARBOR VITAE ST 39FT S & 30FT W C/L INT	DY 6898
HAWTHRNE (1990)	89.711	LA CITY TRI MON IN WELL 10IN DN @ C/L INT LA CIENEGA BLVD & CENTURY BLVD MKD (ING G7 RESET 1963)	DY 6899
HAWTHRNE (1990)	82.555	RDBM TAG S CB 11FT E/O BCR @ SE COR LA CIENEGA BLVD & LENNOX BLVD 32FT S & 73FT E C/L INT	DY 6901
HAWTHRNE (1990)	79.599	LA CITY HEX BAR MON IN WELL 10IN DN @ C/L INT LA CIENEGA BLVD & 111TH ST	DY 6902
HAWTHRNE (1990)	84.857	RDBM TAG E CB 3FT N BCR @ NE COR IMPERIAL HWY & LA CIENEGA BLVD 70FT N & 40FT E C/L INT	DY 6904
HAWTHRNE (1990)	84.925	RDBM TAG N CB 1FT E BCR @ NW COR IMPERIAL HWY & LA CIENEGA BLVD 58FT N & 60FT W C/L INT	DY 6905
HAWTHRNE (1990)	85.221	USC&GS MON FL S CB 1FT W BCR @ SW COR LA CIENEGA BLVD & IMPERIAL HWY 38FT S & 76FT W C/L INT MKD (H 1654 1960)	DY 6906
HAWTHRNE (1990)	86.230	CS MON IN WELL 10IN DN @ C/L INT LA CIENEGA BLVD & 120TH ST MKD (RE 529)	DY 6907
HAWTHRNE (1990)	88.371	RDBM TAG E CB 1FT N BCR @ NE COR LA CIENEGA BLVD EL SEGUNDO BLVD 32FT N & 32FT E C/L INT	DY 6909
HAWTHRNE (1990)	84.174	RDBM TAG E CB 1FT S BCR @ SE COR LA CIENEGA BLVD & 134TH ST 31FT S & 18FT E C/L INT	DY 6911
HAWTHRNE (1990)	83.769	RDBM TAG E CB 1FT S BCR @ SE COR LA CIENEGA BLVD & 134TH ST 31FT S & 23FT E C/L INT	DY 6912
BASELINE (1990)	97.477	L&BN E CB HAWTHORNE BLVD 40FT E/O C/L & 64FT S/O C/L PACIFIC COAST HWY 2FT S/O BCR	DY 6922
BASELINE (1990)	77.991	CS BUTTON BR CAP MON FL SE COR CONC CULV 42FT N & 130FT E C/L INT PACIFIC COAST HWY & E DR TO SO HIGH SCHOOL MKD (BM 21-56A 1960 RE 5869)	DY 6924
BASELINE (1990)	87.582	USC&GS MON N COLUMN OF PED OVERHD WK FOR PACIFIC COAST HWY 47FT N C/L 4FT UP 0.8MI W/O HAWTHORNE BLVD 122FT W/O E DR OF HIGHSCHOOL MKD(1053 1960)	DY 6925
BASELINE (1990)	96.509	S&L IN NW COR C B IN S CB 38FT S & 211FT E/O C/L INT PACIFIC COAST HWY & CALLE MAYOR MKD(BM-21-55A)	DY 6926

QUAD-YEAR	ELEV	DESCRIPTION (INCLUDE QUAD AND YEAR IN DESCRIPTION)	BM NUMBER
BASELINE (1990)	129.874	USC&GS MON FL W END CONC CULV 37FT S C/L PACIFIC COAST HWY 462FT E/O INT PASEO DE GRACIA ACROSS FR & 76FT W/O MCCORMICK MORTUARY MKD (X-1053 1960)	DY 6927
TORRANCE (1990)	15.125	USC&GS MON VERT IN WL @ SW COR HERMOSA AVE & 13TH ST 50FT WLY & 30FT S C/L INT MKD (T50 1925)	DY 6934
TORRANCE (1990)	12.825	CS BR CAP MON IN WELL @ C/L INT THE STRAND & 19TH ST MKD (TORRANCE D-4)	DY 6935
TORRANCE (1990)	49.400	CS BR CAP MON IN WELL SW COR CRENSHAW BLVD & COMPTON BLVD 192FT S P 40FT W/O C/L INT MKD (BM 22-1A 1953)	DY 6936
TORRANCE (1990)	47.307	FLAT SPK S CB 7FT W BCR @ SW COR CRENSHAW BLVD & MANHATTAN BEACH BLVD 43FT S & 85FT W C/L INT	DY 6937
TORRANCE (1990)	38.771	CS BR CAP MON IN WELL NE COR 166TH ST & ATKINSON AVE 19FT N/O C/L & 30FT E/O E CB LINE MKD (BM 22-3A 1960) RE 5869	DY 6941
TORRANCE (1990)	55.128	L&BN W CB 1FT N BCR @ SW COR CRENSHAW BLVD & ARTESIA BLVD 65FT S & 38FT W/O C/L INT MKD(BM)	DY 6942
TORRANCE (1990)	63.306	L&BRAD S CB 3FT W BCR @ SW COR CRENSHAW BLVD & 181ST ST 18FT S & 80FT W/O C/L INT	DY 6943
BASELINE (1990)	79.836	LACS MON IN WELL 17IN DN ON C/L SEPULVEDA BLVD 137FT E/O HAWTHORNE BLVD PROD FROM S MKD (TORRANCE K-9 1942)	DY 6953
BASELINE (1990)	80.785	CS MON IN WELL ON C/L SEPULVEDA BL 64FT W/O C/L INT HAWTHORNE BLVD MKD(TORRANCE J-9 1942 RE 2177	DY 6954
BASELINE (1990)	78.375	CS MON 9IN DN 6FT E C/L HAWTHORNE AVE & 125FT N C/L 230TH ST MKD (BM 22-15A 1960)	DY 6955
BASELINE (1990)	47.145	CS BR CAP MON IN WELL @ SELY COR ESPLANADE & AVE I 124FT SLY & 18FT ELY C/L INT MKD (TORRANCE F 10 RE 2177 1939)	DY 7238
BASELINE (1990)	48.136	CS MON IN WELL @ C/L INT AVE I & ESPLANADE	DY 7239
BASELINE (1990)	49.252	USC&GS MON FLUSH @ NE COR ESPLANADE & AVE I 40FT N & 44FT E/O C/L INT MKD(D 768-1945)	DY 7240
TORRANCE (1990)	63.356	RD MON 8IN DN @ C/L INT INGLEWOOD AVE & 147TH ST TO THE E MKD (RD 1959)	DY 7242

QUAD-YEAR	ELEV	DESCRIPTION (INCLUDE QUAD AND YEAR IN DESCRIPTION)	BM NUMBER
TORRANCE (1990)	60.764	L&BN W CB 57FT N BCR @ NW COR INGLEWOOD AVE & COMPTON BLVD 116FT N & 30FT W C/L INT	DY 7245
TORRANCE (1990)	60.914	L&BN W CB 1FT S BCR @ SW COR INGLEWOOD AVE & COMPTON BLVD 60FT S & 32FT W C/L INT MKD (BM)	DY 7246
TORRANCE (1990)	57.386	L&SPK N CB 18FT E BCR @ NE COR INGLEWOOD AVE & 153RD PL 15FT N & 78FT E C/L INT MKD (SD 3011)	DY 7247
BASELINE (1990)	206.518	LACE MON IN WELL 10IN DN @ C/L INT CRENSHAW BLVD & 76TH ST	DY 7843
BASELINE (1990)	240.419	RDBM TAG 4FT E BCR 18FT N & 69FT E C/L INT CRENSHAW BLVD & 80TH ST	DY 7844
BASELINE (1990)	224.444	L & BN 2FT W BCR 18FT S & 49FT W C/L INT 8TH AVE & 80TH ST TO W	DY 7845
BASELINE (1990)	210.145	L & BR IN E CB 8TH AVE 20FT E/O C/L ON C/L PROD 84TH ST TO W	DY 7846
BASELINE (1990)	209.967	L&BR 2FT S BCR 47FT S & 20FT W/O C/L INT 8TH AVE & 84TH ST TO W	DY 7847
BASELINE (1990)	213.629	L&T 4FT N/O BCR 83FT N & 38FT E/O C/L INT CRENSHAW BLVD & 90TH ST TO THE E	DY 7848
BASELINE (1990)	206.305	L & PK 4FT N BCR 33FT N & 38FT E C/L INT CRENSHAW BLVD & ARBOR VITAE ST TO E	DY 7850
BASELINE (1990)	194.091	L & DN IN NE COR C B 44FT S & 42FT E C/L INT CRENSHAW BLVD & HARDY ST	DY 7852
BASELINE (1990)	127.447	L&DN IN NE COR C B 75FT N & 42FT E/O C/L INT CRENSHAW BLVD & 104TH ST	DY 7853
BASELINE (1990)	124.688	L&BR 8FT S/O BCR OF ISLE 34FT S & 41FT E/O C/L INT CRENSHAW BLVD & 104TH ST	DY 7854
BASELINE (1990)	91.910	SPK&L IN CB 10FT S & 38FT E C/L INT CRENSHAW BLVD & 109TH ST (TO THE W)	DY 7855
BASELINE (1990)	70.800	L & BR IN CB 40FT E C/L CRENSHAW BLVD @ C/L PROD 116TH ST TO W	DY 7857
BASELINE (1990)	70.087	L&SPK IN W CB 38FT W 65FT S/O C/L INT CRENSHAW BLVD & 116TH ST TO W (MKD KE-6)	DY 7858
BASELINE (1990)	53.971	RDBM TAG IN CONC BASE TRAFFIC LIGHT 53FT S & 43FT W/O C/L INT CRENSHAW BLVD & NORTHROP AVE	DY 7859

QUAD-YEAR	ELEV	DESCRIPTION (INCLUDE QUAD AND YEAR IN DESCRIPTION)	BM NUMBER
BASELINE (1990)	49.444	L AFC BR CAP MON FL IN N ABUT TO BRIDGE OVER F C CHANNEL 50FT E/O C/L CRENSHAW BLVD & 191FT N/O 132ND ST MKD (BM 114-63 1959)	DY 7860
BASELINE (1990)	46.524	L&BN IN N WALL L AFC CHANNEL 49FT W/O C/L CRENSHAW BLVD & 187FT N C/L 132ND ST	DY 7861
BASELINE (1990)	46.314	RDBM TAG IN W CB 8FT N & 40FT W C/L INT CRENSHAW BLVD & 134TH ST	DY 7862
BASELINE (1990)	47.213	CS BR CAP MON NE COR C B 19FT N & 65FT W C/L INT CRENSHAW BLVD & 139TH ST MKD (BM 27-77A 1965 5869)	DY 7863
BASELINE (1990)	47.163	L&SPK IN N END C B 1FT W/O CB 36FT S & 41FT W/O C/L INT 139TH ST & CRENSHAW BLVD	DY 7864
BASELINE (1990)	162.275	BR DISK 43FT N BCR 100FT N & 28FT E C/L INT FLORENCE AVE & WEST BLVD MKD (OJA 1968 MWD)	DY 8237
BASELINE (1990)	163.964	USC&GS MON FL IN NW COR C B 3FT NLY CB 58FT NLY & 56FT WLY C/L INT FLORENCE AVE & PRAIRIE AVE MKD(K 973 - 1964)	DY 8240
BASELINE (1990)	152.990	USC&GS BR DISK 1FT N/O CB 12FT W/O BCR 46FT N & 73FT W C/L INT FLORENCE AVE & CENTINELA AVE MKD (N 978 -1964)	DY 8241
BASELINE (1990)	85.924	L & N 3FT N BCR 35FT NLY & 17FT ELY C/L INT HYDE PARK BLVD & GLENWAY DR	DY 8242
BASELINE (1990)	85.988	L & B 5FT NLY BCR 41FT NLY & 17FT WLY C/L INT HYDE PARK BLVD & GLENWAY DR	DY 8243
BASELINE (1990)	84.254	L&SPK 0.7FT E BCR 18FT N & 58FT ELY C/L INT LA TIJERA BLVD & THORNBURN ST	DY 8245
HAWTHRNE (1990)	68.579	USC&GS MON 6FT E BCR @ NE COR IMPERIAL HWY & PRAIRIE AVE 40FT N & 62FT E C/L INT MKD (P 1054 1960)	DY 8257
HAWTHRNE (1990)	76.458	RDBM TAG 3FT E BCR @ NE COR IMPERIAL HWY & INGLEWOOD AVE 40FT N & 47FT E C/L INT	DY 8258
HAWTHRNE (1990)	76.759	L & BN @ NW COR IMPERIAL HWY & INGLEWOOD AVE 40FT N & 44FT W C/L INT MKD (BM)	DY 8259
HAWTHRNE (1990)	42.782	CITY OF LA MON IN WELL 10IN DN @ C/L INT VISTA DEL MAR & IMPERIAL HWY MKD (VENICE H 9 1951)	DY 8273
HAWTHRNE (1990)	44.121	CUT SPK IN NW COR C B 379FT N & 31FT E/O C/L INT VISTA DEL MAR & IMPERIAL HWY	DY 8274

QUAD-YEAR	ELEV	DESCRIPTION (INCLUDE QUAD AND YEAR IN DESCRIPTION)	BM NUMBER
HAWTHRNE (1990)	83.871	L & T 7FT W BCR @ NW COR LA CIENEGA BLVD & 104TH DY ST 27FT N & 75FT W C/L INT	8275
HAWTHRNE (1990)	81.781	L&BRAD 46FT W C/L LA CIENEGA BLVD & 32FT S C/L LENNOX BLVD	DY 8276
HAWTHRNE (1990)	80.533	CITY OF LA BM MON FL IN C B @ SW COR LA CIENEGA BLVD & 111TH ST 50FT S & 45FT W/O C/L INT 6FT S/O BCR 2FT BACK OF CB MKD (PBM 17.12700)	DY 8277
HAWTHRNE (1990)	16.143	CS MON IN WELL 12IN DN 48FT E/O INGLEWOOD BLVD & 51FT N/O JEFFERSON BLVD (NR CTR CB RET @ NE COR) MKD -BM 2A 1970-	DY 8279
HAWTHRNE (1990)	10.599	CT SPK 2FT E BCR @ SE COR CULVER BLVD & VISTA DEL MAR LN 28FT S & 23FT E/O C/L INT	DY 8282
HAWTHRNE (1990)	54.586	USC & GS MON FL IN RET WL @ NELY COR VISTA DEL MAR & WATERVIEW ST 71FT ELY & 36FT NLY C/L INT MKD (S767 1945)	DY 8283
HAWTHRNE (1990)	50.033	WIRE SPK 20FT NLY BCR @ NE COR GILLIS ST & VISTA DEL MAR 44FT NLY & 25FT ELY C/L INT	DY 8284
HAWTHRNE (1990)	46.357	LACE MON IN WELL 11IN DN 20FT E & 453FT S/O INT VISTA DEL MAR & PALACE ST (NEAR OLD INT VISTA DEL MAR & STERRY ST)	DY 8286
HAWTHRNE (1990)	49.704	USC & GS MON 3.6FT NLY OF NELY COR OF OLD LIFE GUARD STA 5.2FT WLY CB VISTA DEL MAR 421FT SLY CENTURY BLVD MKD (R767 1945)	DY 8289
HAWTHRNE (1990)	55.931	CT SPK @ NELY COR VISTA DEL MAR & DEAUVILLE ST 75FT NLY & 30FT ELY C/L INT	DY 8290
HAWTHRNE (1990)	51.509	USC&GS MON FL IN C B @ NELY COR VISTA DEL MAR & HAVILAND ST 34FT ELY & 67FT NLY C/L INT MKD (T 767 1945)	DY 8293
HAWTHRNE (1990)	49.169	CUT SPK NELY COR VISTA DEL MAR & JACQUELIN ST 30FT ELY & 66FT NLY C/L INT	DY 8294
HAWTHRNE (1990)	36.751	WIRE SPK 1FT NLY BCR @ NELY COR VISTA DEL MAR & GRAND AVE 50FT NLY & 20FT ELY C/L INT	DY 8298
HAWTHRNE (1990)	86.849	SC EDISON MON 10IN DN @ SW COR OF SC EDISON CO EL SEGUNDO GENERATING STA 74FT SELY OF NE COR GUARD BLDG 16FT ELY FIRE HYDRANT 5.8FT WLY OF W CB VISTA DEL MAR & 0.1MI N/O INT 45TH ST MKD LS 2619 27 1A CO ENGR)	DY 8301

QUAD-YEAR	ELEV	DESCRIPTION (INCLUDE QUAD AND YEAR IN DESCRIPTION)	BM NUMBER
BASELINE (1990)	114.409	CS MON IN WELL 2FT N CB FACE 44FT N C/L ROSECRANS AVE & 6FT W C/L FLOURNOY RD MKD (BM 21-23A 1970)	DY 8302
BASELINE (1990)	162.587	CS MON IN WELL 8IN DN 43FT N/O C/L ROSECRANS AVE & 6FT W/O C/L OAK AVE MKD (BM 21-22D 1970)	DY 8303
BASELINE (1990)	163.658	L&BR IN S CB ISLAND ON C/L OAK AVE & 4FT S/O C/L ROSECRANS AVE	DY 8304
BASELINE (1990)	72.821	CS MON IN WELL 8IN DN @ SW COR ROSECRANS AVE & MANSEL AVE 62FT S & 18FT W/O C/L INT MKD (BM 21-16A)	DY 8307
TORRANCE (1990)	94.253	L & BN IN N CB 1FT W BCR @ NW COR HAWTHORNE BLVD & REDONDO BEACH BLVD 12FT S & 91FT W C/L INT STPD (BM)	DY 8322
TORRANCE (1990)	118.063	L & T NR CTR CB RET @ SE COR ARTESIA BLVD & INGLEWOOD AVE 46FT S & 46FT E C/L INT	DY 8324
TORRANCE (1990)	68.897	RDBM TAG IN S CB 25FT E BCR @ SE COR INGLEWOOD AVE & 162ND ST 62FT E & 16FT S C/L INT	DY 8340
TORRANCE (1990)	59.614	RDBM TAG IN W CB 1FT S BCR @ NW COR INGLEWOOD AVE & MANHATTAN BEACH BLVD 32FT W & 76FT N C/L INT	DY 8341
TORRANCE (1990)	47.778	L&T IN SO CB ISL COLLEGE SERVICE RD 60FT S & 50FT E C/L INT MANHATTAN BEACH BLVD & LEMOLI AVE	DY 8342
TORRANCE (1990)	47.800	L & T IN E CB 40FT E C/L PRAIRIE AVE ON C/L PROD 162ND ST	DY 8351
TORRANCE (1990)	47.832	RDBM TAG IN N CB 28FT W ECR @ NW COR PRAIRIE AVE & 162ND ST 23FT N & 93FT W C/L INT	DY 8352
TORRANCE (1990)	49.845	L & T W CB 3FT S BCR @ NW COR PRAIRIE AVE & 166TH ST 41FT N & 40FT W C/L INT	DY 8353
TORRANCE (1990)	62.856	L & BN 1FT W BCR @ NW COR REDONDO BEACH BLVD & PRAIRIE AVE 43FT N & 59FT W C/L INT	DY 8355
TORRANCE (1990)	106.661	RDBM TAG IN E CB 2FT S/O ECR @ NE COR TORRANCE BLVD & ANZA AVE 72FT N & 38FT E C/L INT	DY 8360
TORRANCE (1990)	107.374	RDBM TAG IN N CB 11FT W BCR @ NE COR TORRANCE BLVD & HENRIETTA AVE 40FT N & 46FT E C/L INT	DY 8362
TORRANCE (1990)	118.444	L & T IN S CB 2FT E BCR @ SE COR TORRANCE BLVD & JUANITA AVE 25FT S & 15FT E C/L INT	DY 8364

QUAD-YEAR	ELEV	DESCRIPTION (INCLUDE QUAD AND YEAR IN DESCRIPTION)	BM NUMBER
TORRANCE (1990)	118.131	L&T IN W CB 41FT N/O C/L TORRANCE BLVD & 20FT W/O C/L JUANITA AVE (15FT N/O BCR @ NW COR)	DY 8365
TORRANCE (1990)	68.246	USC&GS MON FL IN E CB 3FT S/O BCR @ SE COR ESPLANADE & AVE A 38FT S & 30FT E C/L INT MKD (REDONDO 1927)	DY 8368
TORRANCE (1990)	68.951	USC&GS MON FL 47FT W/O & 11FT N/O C/L INT ESPLANADE & AVE A MKD (REDONDO 1927) 2FT BACK OF BACK WK CB	DY 8369
TORRANCE (1990)	53.057	RDBM TAG IN E CB 26FT S BCR @ SE COR ESPLANADE & SAPPHIRE ST 54FT S & 26FT E C/L INT	DY 8370
TORRANCE (1990)	6.966	CS BR CAP MON IN WELL 16FT W & 228FT S C/L INT HARBOR DR & MARINA WAY MKD (TOR E7A 1939 RE 2177)	DY 8375
TORRANCE (1990)	8.363	RDBM TAG IN E CB 58FT S & 29FT E C/L INT HARBOR DR & MARINA WAY	DY 8376
TORRANCE (1990)	12.511	CS BR CAP MON IN WELL ON C/L THE STRAND & 15FT N C/L WK LYNDON ST MKD (TOR E-6A 1939 RE 2177)	DY 8377
TORRANCE (1990)	11.758	RDBM TAG IN S CB 7FT W ECR @ SW COR HERMOSA AVE & 2ND ST 20FT S & 54FT W C/L INT	DY 8378
TORRANCE (1990)	11.810	LAFC TAG E CB 4FT N BCR @ NE COR HERMOSA AVE & 2ND ST 44FT E & 29FT N C/L INT	DY 8379
TORRANCE (1990)	12.728	L & T IN CONC SLAB @ SW COR BEACH DR & 19TH ST 14FT W & 8FT S C/L INT (STPD BM)	DY 8380
TORRANCE (1990)	23.180	USC&GS MON FL IN 1ST STEP OF WK @ SE COR HERMOSA AVE & 25TH ST 32FT S & 52FT E C/L INT MKD (Z-767 1945)	DY 8381
TORRANCE (1990)	27.280	RDBM TAG IN TOP CONC CB 32FT W & 17FT S C/L INT HERMOSA AVE & 30TH ST	DY 8383
TORRANCE (1990)	28.035	RDBM TAG IN E CB 4FT N BCR @ NE COR HERMOSA AVE & 30TH ST 32FT E & 24FT N C/L INT	DY 8384
TORRANCE (1990)	23.822	USC&GS MON IN WELL 99FT S & 9FT W C/L INT MANHATTAN BEACH BLVD & THE STRAND 2FT W/O WALL MKD (S-50 1925)	DY 8387
TORRANCE (1990)	21.899	CS BR CAP MON IN WELL 32FT W & 4FT S C/L INT THE STRAND & MANHATTAN BEACH BL MKD (TOR C-2 1939 RE 2177)	DY 8389

QUAD-YEAR	ELEV	DESCRIPTION (INCLUDE QUAD AND YEAR IN DESCRIPTION)	BM NUMBER
TORRANCE (1990)	34.849	USC&GS MON FL IN 1ST STEP BELOW CONC WK @ STAIR TO BEACH 7FT W/O C/L THE STRAND & NR C/L PROD MARINE AVE MKD (J 1052 1960)	DY 8392
TORRANCE (1990)	32.296	BT SPK IN L IN W CB 7FT W & 64FT S C/L INT THE STRAND & 28TH ST	DY 8393
BASELINE (1990)	42.204	RDBM TAG IN SW COR CONC WK 21FT N & 7.5FT E C/L INT THE STRAND & ROSECRANS AVE	DY 8395
BASELINE (1990)	76.125	RDBM TAG IN E CB 3FT N ECR @ NE COR PACIFIC COAST HWY & ANZA AVE 49FT N & 40FT E/O C/L INT	DY 8396
BASELINE (1990)	103.727	RDBM TAG IN E CB 3FT S ECR @ NE COR PACIFIC COAST HWY & CALLE MAYOR 67FT N & 40FT E C/L INT	DY 8398
BASELINE (1990)	129.578	RDBM TAG IN N CB IN FRONT STREET LIGHT 37FT N C/L PACIFIC COAST HWY & 386FT E/O INT PASEO DE GRACIA IN FRONT OF E SIDE MC CORMICK MORTUARY	DY 8399
BASELINE (1990)	109.731	RDBM TAG IN S CB OF PACIFIC COAST HWY 2FT E/O BCR @ SE COR OF VISTA DEL PARQUE (MOST WLY INT) & 38FT S & 39FT E/O INT	DY 8400
BASELINE (1990)	85.073	USC&GS BR DISK FL IN WALK @ SE COR PACIFIC COAST HWY & PALOS VERDES BLVD PKWY 40FT S & 29FT E C/L INT MKD (E-768 RESET 1962)	DY 8402
BASELINE (1990)	68.019	RAMSET IN W CB AVE I 42FT W C/L & 59FT S/O C/L PACIFIC COAST HWY 10FT N/O BCR	DY 8403
BASELINE (1990)	76.491	CS BR CAP MON 575FT S INT SKYPARK DR E & 39FT E/O C/L HAWTHORNE BL MKD (TOR K11 RESET 1961 RE5869)	DY 8425
BASELINE (1990)	77.433	CS BUTTON BR CAP MON IN WELL 6FT E C/L HAWTHORNE BL & 100FT N C/L SKYPARK DR W MKD (BM 22-16B 196	DY 8426
BASELINE (1990)	77.439	L & BRAD 1FT N BCR INTO RET @ SE COR HAWTHORNE BLVD & LOMITA BLVD 137FT S & 55FT E C/L INT	DY 8427
BASELINE (1990)	77.350	RDBM TAG 2FT N BCR @ NE COR HAWTHORNE BLVD & LOMITA BLVD 31FT N & 55FT E C/L INT	DY 8428
BASELINE (1990)	78.270	RAM SET 0.7FT S BCR IN RET @ NE COR HAWTHORNE BLVD & 230TH ST 40FT N & 55FT E C/L INT	DY 8429
BASELINE (1990)	78.968	LACS MON FL IN C B ON SE COR SEPULVEDA BLVD & MADRONA AVE 40FT S & 67FT E C/L INT MKD (-N 22-12B RE 5869 1970)	DY 8430

QUAD-YEAR	ELEV	DESCRIPTION (INCLUDE QUAD AND YEAR IN DESCRIPTION)	BM NUMBER
BASELINE (1990)	83.448	L & BRAD 1FT E BCR INTO RET @ SW COR SEPULVEDA BLVD & MAPLE AVE 38FT S & 63FT W C/L INT	DY 8431
BASELINE (1990)	68.701	RDBM TAG 8FT S BCR @ SE COR CRENSHAW BLVD & DEL AMO BLVD 95FT S & 40FT E C/L INT	DY 8433
BASELINE (1990)	68.518	RDBM TAG 2FT N BCR @ NE COR CRENSHAW BLVD & DEL AMO BLVD 72FT N & 42FT E C/L INT	DY 8434
BASELINE (1990)	56.085	BT SPK 26FT N BCR @ NW COR CRENSHAW BLVD & 1ST ALLEY N/O 190TH ST 14FT W & 48FT N C/L INT MKD(BM 22-7A)	DY 8435
BASELINE (1990)	49.909	CS MON 2IN DN 1.5FT BACK CB @ SW COR CRENSHAW BLVD & COMPTON BLVD 78FT S & 39.5 W C/L INT MKD (BM 22-1 1952)	DY 8436
BASELINE (1990)	159.918	L&T S CB FLORENCE AVE NR C/L PROD WEST BLVD 35FT S/O C/L INT	DY 9233
BASELINE (1990)	151.734	L&PK 2FT W/O BCR @ SW COR FLORENCE AVE & LOCUST ST 40FT S & 160FT W/O C/L INT	DY 9235
BASELINE (1990)	114.739	USC&GS MON IN CONC CB @ ENT TO OVERHEAD PARKING LOT 20 N/O CABLE PL & 200FT W/O C/L IVY AVE MKD (N-417 RESET 1973)	DY 9236
BASELINE (1990)	77.563	L&SPK 1FT N/O BCR @ NE COR GLASGOW AVE & THORNBURN ST 39FT N & 18FT E/O C/L INT	DY 9238
BASELINE (1990)	77.375	L&SPK IN S CB THORNBURN ST 18FT S/O C/L NEAR C/L PROD GLASGOW AVE	DY 9239
HAWTHRNE (1990)	22.411	L&BN IN SLY CB CENTINELA AVE 42FT SLY & 56FT WLY C/L PROD MESMER AVE	DY 9240
HAWTHRNE (1990)	21.651	L&BR IN SLY CB ISLAND 55FT WLY BCR 45FT NLY & 203FT C/L INT CENTINELA AVE & MESMER AVE	DY 9241
HAWTHRNE (1990)	13.834	LACE MON ELY CB CENTINELA AVE (TO N) 38FT E & 87FT N/O C/L INT JEFFERSON BLVD 35FT N/O BCR @ S END C B MKD (CITY OF L A PBM)	DY 9242
HAWTHRNE (1990)	13.335	L&RD TAG NEAR C/L PROD CENTINELA AVE (TO N) 42FT S/O C/L JEFFERSON BLVD	DY 9243
HAWTHRNE (1990)	14.150	LACE MON IN N CB JEFFERSON BLVD 10FT W/O BCR @ NW COR JEFFERSON BLVD & WESTLAWN AVE 43FT N & 71FT W/O C/L INT MKD (CITY OF LA PBM)	DY 9245

QUAD-YEAR	ELEV	DESCRIPTION (INCLUDE QUAD AND YEAR IN DESCRIPTION)	BM NUMBER
HAWTHRNE (1990)	13.928	LACE MON IN CONC BASE OF SIGNAL BOX ON SO SIDE OF JEFFERSON BLVD 45FT S & 50FT E/O C/L INT JEFFERSON BLVD & BEETHOVEN ST MKD (CITY OF LA PBM)	DY 9246
HAWTHRNE (1990)	12.960	L&BN IN N CB JEFFERSON BLVD @ NE COR JEFFERSON BLVD & BEETHOVEN ST 42FT N & 48FT E/O C/L INT (1FT E/O BCR)	DY 9247
HAWTHRNE (1990)	11.871	RAM SET N CB JEFFERSON BLVD @ NE COR JEFFERSON BLVD & ALLA RD 42FT N & 66FT E/O C/L INT MKD (XX1V)	DY 9248
HAWTHRNE (1990)	12.261	LACE MON IN WK @ N END OF C B 12FT N/O BCR 83FT N/O JEFFERSON BLVD & 39FT W/O ALLA RD MKD (CITY OF LA PBM)	DY 9249
HAWTHRNE (1990)	11.819	LACE MON IN E CB LINCOLN BLVD @ NE COR LINCOLN BLVD & JEFFERSON BLVD 20FT N/O BCR 49FT E & 97FT N/O C/L INT MKD (CITY OF LA PBM)	DY 9250
HAWTHRNE (1990)	11.223	RDBM TAG IN N CB JEFFERSON BLVD @ NW COR JEFFERSON BLVD & LINCOLN BLVD 42FT N & 97FT W/O C/L INT (2FT W/O BCR)	DY 9251
HAWTHRNE (1990)	3.445	L&BN IN NLY CB CULVER BLVD 28FT N & 40FT W/O C/L NICHOLSON ST (12FT W/O CB ENT)	DY 9252
HAWTHRNE (1990)	43.608	CUT SPK IN W CB VISTA DEL MAR 21FT W/O C/L & 0.25MI S/O INT IMPERIAL HWY OPP ENTRANCE DRIVE HYPERION TREATMENT PLANT GATE C	DY 9254
HAWTHRNE (1990)	36.453	LAFC BR DISK IN W CB VISTA DEL MAR 22FT W/O C/L ON APPROX C/L PROD GRAND AVE	DY 9256
HAWTHRNE (1990)	45.269	RDBM TAG IN TOP OF UNDERPASS 28FT W/O C/L VISTA DEL MAR & 0.25MI S/O INT GRAND AVE (2FT N/O SOUTH END OF UNDERPASS)	DY 9258
BASELINE (1990)	108.508	RDBM TAG 10FT W/O BCR SW COR ROSECRANS AVE & BELL AVE 42FT S & 54FT W/O C/L INT	DY 9259
BASELINE (1990)	105.381	LACS BM MON IN WELL 2FT N/O N CB ROSECRANS AVE 44FT N/O C/L & 37FT E/O C/L PROD BELL AVE (21-69A CO ENG)	DY 9260
BASELINE (1990)	110.217	RDBM TAG 2FT W/O BCR SW COR ROSECRANS AVE & PACIFIC AVE 41FT S & 44FT W/O C/L INT	DY 9261
BASELINE (1990)	92.457	L&LS TAG NO 2767 E CB NASH ST @ BCR NE COR ROSECRANS AVE 32FT E & 78FT N/O C/L INT	DY 9262

QUAD-YEAR	ELEV	DESCRIPTION (INCLUDE QUAD AND YEAR IN DESCRIPTION)	BM NUMBER
BASELINE (1990)	93.325	RDBM TAG N CB ROSECRANS AVE 1FT W/O BCR @ NW COR APOLLO ST 41FT N & 67FT W/O C/L INT	DY 9263
BASELINE (1990)	86.907	RDBM TAG 1FT E/O BCR @ NE COR ROSECRANS AVE & DOUGLAS ST 42FT N & 60FT E/O C/L INT	DY 9265
BASELINE (1990)	79.368	RDBM TAG SLY CB 1FT E/O BCR @ SW COR ROSECRANS AVE & ISIS AVE 40FT S & 71FT W/O C/L INT	DY 9266
BASELINE (1990)	83.608	LACS BM MON IN WELL 11FT N/O N CB ROSECRANS AVE 50FT N/O C/L & 186FT W/O INT HINDRY AVE 1FT W/O E WALL TO HAWTHORNE FIRE STA NO 3	DY 9267
BASELINE (1990)	59.734	RDBM TAG S CB ROSECRANS AVE ON APPROX C/L PROD WASHINGTON AVE 40FT S/O C/L	DY 9268
BASELINE (1990)	51.015	LACS BM MON IN SLY WALL LAGUNA DOMINGUEZ CHANNEL 1FT SW OF SW COR BRIDGE NO 1276 SW COR ROSECRANS AVE & CRENSHAW BLVD 241FT S & 43FT W/O C/L INT MKD (21- 12A 1964 RE 5869)	DY 9269
BASELINE (1990)	170.538	L&PK IN CB RET NE COR CRENSHAW BLVD & CENTURY BLVD 66FT E & 38FT N/O C/L INT 2FT W/O BCR	DY 9271
BASELINE (1990)	207.963	RDBM TAG S CB 1FT E/O BCR S-E COR CRENSHAW BLVD & 76TH ST TO THE E 51FT E & 18FT S/O C/L INT	DY 9272
TORRANCE (1975)	42.743	RDBM TAG TOP CONC WALL 50FT N/O C/L 16TH ST & 8FT W/O C/L THE STRAND 1FT N/O END RAIL	DY 9339
TORRANCE (1975)	42.334	RDBM TAG IN CONC WK 18FT S/O C/L 16TH ST & 8FT W/O C/L THE STRAND S SIDE ENTRANCE TO STAIRWAY	DY 9340
TORRANCE (1975)	27.170	CS BR CAP MON IN TOP OF WALL 7FT W/O C/L THE STRAND & 2FT N C/L 6TH ST WK MKD (BM 21-31A 1973 RE 7078)	DY 9341
TORRANCE (1975)	12.962	CS BR CAP MON IN WELL 10FT E/O W EDG WK THE STRAND 6FT S/O NLY EDG WK 5TH ST PROD MKD (TORRANCE E-6 B 1939 RE 2177)	DY 9344
TORRANCE (1975)	10.945	BR DISK IN WK 2FT BK OF E CB & 8FT S/O BCR SE COR HARBOR DR 11TH ST & YACHT CLUB WAY 31FT E & 35FT S/O C/L INT MKD (BM H-1 1960 RE 7858)	DY 9345
TORRANCE (1975)	12.239	SCEC BR CAP MON DN 2IN SE COR HARBOR DR 11TH ST & YACHT CLUB WAY 70FT E & 42FT S/O C/L INT MKD (BM 1-1956)	DY 9346
TORRANCE (1990)	68.684	RDBM TAG E CB 1FT N BCR NE COR TORRANCE BLVD & CATALINA AVE 87FT N & 45FT E/O C/L INT	DY 9348

QUAD-YEAR	ELEV	DESCRIPTION (INCLUDE QUAD AND YEAR IN DESCRIPTION)	BM NUMBER
TORRANCE (1990)	64.011	RDBM TAG W CB 2FT S/O BCR SW COR TORRANCE BLVD & CATALINA AVE 90FT S & 45FT W/O C/L INT	DY 9349
BASELINE (1990)	83.519	RDBM TAG IN CB 5FT E/O BCR NE COR PACIFIC COAST HWY & PALOS VERDES BLVD 37FT N& 74FT E/O C/L INT	DY 9351
BASELINE (1990)	106.965	RDBM TAG IN N CB OF PACIFIC COAST HWY 6FT W/O BCR @ NW COR OF VISTA DEL PARQUE (MOST WLY INT) & 37FT N & 54FT W/O INT	DY 9352
BASELINE (1990)	77.055	RDBM TAG S CB 1FT E/O BCR SE COR PACIFIC COAST HWY & ANZA AVE 40FT S & 86FT E/O C/L INT	DY 9353
BASELINE (1990)	77.623	L&N 16FT N/O BCR @ NW COR CRENSHAW BLVD & SEPULVEDA BLVD 48FT W & 119FT N/O C/L INT	DY 9354
BASELINE (1990)	87.352	L&BD 1FT W/O BCR @ SE COR CARSON ST & CRENSHAW BLVD 42FT S & 67FT E/O C/L INT	DY 9355
BASELINE (1990)	65.383	CS MON FL 2FT E/O CB @ SW COR C B 41FT E/O C/L CRENSHAW BLVD & 0.2MI N/O C/L DEL AMO BLVD MKD (BM 22-7D 1970 RE 5869)	DY 9359
BASELINE (1990)	47.748	CSBM MON FL IN W WALL C B 30FT E/O BCR @ SE COR CRENSHAW BLVD & MANHATTAN BEACH BLVD 40FT S & 107FT E/O C/L INT MKD (BM 22-2B 1974)	DY 9361
HAWTHRNE (1990)	68.490	RDBM TAG IN S CB IMPERIAL HWY 1FT W OF BCR @ SW COR CEDAR AVE 38FT S & 39FT W C/L INT	DY 9451
HAWTHRNE (1990)	68.499	RDBM TAG SW COR IMPERIAL HWY & HAWTHORNE BLVD 2FT W BCR 38FT S & 108FT W C/L INT	DY 9452
HAWTHRNE (1990)	88.442	RDBM TAG 3FT N BCR @ SE COR LA CIENEGA BLVD EL SEGUNDO BLVD 95FT N & 35FT W C/L INT	DY 9457
HAWTHRNE (1990)	89.465	RDBM TAG 4FT S BCR @ SE COR LA CIENEGA BLVD & CENTURY BLVD 90FT S & 42FT E C/L INT	DY 9458
TORRANCE (1990)	91.129	RD BM TAG E CB 1FT N/O BCR @ NE COR HAWTHORNE BLVD & REDONDO BEACH BLVD 132FT N & 86FT E/O C/L INT	DY 9516
TORRANCE (1990)	74.061	RD BM TAG S CB 1FT W/O BCR @ SW COR REDONDO BEACH BLVD & AMIE AVE 37FT S & 33FT W/O C/L INT	DY 9517
TORRANCE (1990)	118.878	RDBM TAG 5FT W/O BCR @ SW COR ARTESIA BLVD & INGLEWOOD AVE 42FT S & 72FT W/O C/L INT	DY 9522
TORRANCE (1990)	46.343	RD BM TAG IN SO CB 20FT E/O DOTY AVE PROD 38FT SO C/L MANHATTAN BEACH BLVD	DY 9525

QUAD-YEAR	ELEV	DESCRIPTION (INCLUDE QUAD AND YEAR IN DESCRIPTION)	BM NUMBER
TORRANCE (1990)	46.195	RD BM TAG IN N CB 1FT E/O E END C B 38FT N & 104FT W/O C/L INT MANHATTAN BEACH BLVD & DOTY AVE	DY 9526
TORRANCE (1990)	64.004	RD BM TAG IN W CB 10FT N/O APPROX C/L PROD 147TH ST TO THE E 10FT N & 31FT W C/L INT INGLEWOOD AVE & 147TH ST TO THE E	DY 9527
HAWTHRNE (1990)	101.841	RDBM TAG IN CONC CB 2FT S/O BCR 18FT W/O C/L GLASGOW PL & 44FT S/O C/L 138TH PL	DY 10052
HAWTHRNE (1990)	102.404	L&BD IN CONC CB 1FT N/O BCR 18FT W/O C/L GLASGOW PL & 43FT N/O C/L 138TH PL MKD (BM)	DY 10053
TORRANCE (1990)	108.866	RDBM TAG IN S CB TORRANCE BLVD 44FT S/O C/L & 22FT W/O C/L PROD HENRIETTA AVE	DY 10056
TORRANCE (1990)	106.080	L&BR 1FT N/O BCR 40FT W/O C/L ANZA AVE & 75FT S/O C/L TORRANCE BLVD	DY 10057
TORRANCE (1990)	60.151	RDBM TAG IN CONC CB 1FT N/O BCR 42FT N/O C/L 169TH ST & 40FT W/O C/L PRAIRIE AVE 137FT N/O REDONDO BEACH BLVD	DY 10058
BASELINE (1990)	215.051	RDBM TAG E CB 2FT N/O BCR 38FT E/O C/L CRENSHAW BLVD & 76FT N/O C/L MANCHESTER BLVD	DY 10108
BASELINE (1990)	177.118	RDBM TAG ECB OF ENTRANCE CENTINELA CONC VAULT CO (827 REDONDO BLVD) 100FT E & 140FT N/O C/L INT FLORENCE AVE & REDONDO BLVD	DY 10152
BASELINE (1990)	153.119	L&PK IN CB @ NE COR FLORENCE AVE & CENTINELA AVE 45FT N & 90FT E/O C/L INT (2FT W/O BCR)	DY 10153
BASELINE (1990)	151.610	L&T N CB FLORENCE AVE @ OR NEAR C/L PROD LOCUST ST FROM THE SOUTH (45FT N/O C/L FLORENCE AVE)	DY 10154
BASELINE (1990)	112.802	RDBM TAG @ NW COR FLORENCE AVE & EUCALYPTUS AVE 50FT W & 28FT N/O C/L INT (1FT W/O BCR)	DY 10155
BASELINE (1990)	77.426	RDBM TAG IN CB @ NE COR LA CIENEGA BLVD & INDUSTRIAL AVE 15FT N/O C/L INDUSTRIAL AVE & 45FT E/O C/L LA CIENEGA BLVD (1FT E/O BCR)	DY 10156
BASELINE (1990)	78.668	RDBM TAG S CB OF THORNBURN ST 18FT S/O C/L THORNBURN ST & 52FT W/O C/L LA CIENEGA BLVD (1FT W/O BCR)	DY 10157
BASELINE (1990)	51.913	L&BRAD S CB CENTINELA AVE 38FT S/O C/L CENTINELA AVE @ OR NEAR C/L PROD SHERBOURNE DR FROM THE NORTH	DY 10158

QUAD-YEAR	ELEV	DESCRIPTION (INCLUDE QUAD AND YEAR IN DESCRIPTION)	BM NUMBER
BASELINE (1990)	54.531	L&BRAD IN CB @ NE COR ROSECRANS AVE & PRAIRIE AVE 61FT N & 42FT E/O C/L INT (1FT N/O BCR)	DY 10164
BASELINE (1990)	62.422	L&BRAD IN CB @ SE COR ROSECRANS AVE & HAWTHORNE BLVD 40FT S/O C/L ROSECRANS AVE & 44FT E/O C/L HAWTHORNE BLVD (E BARREL) 4FT E/O BCR	DY 10165
BASELINE (1990)	72.235	L&T IN CB @ NE COR ROSECRANS AVE & SHOUP AVE 50FT N & 15FT E/O C/L INT (CTR OF CB RET)	DY 10166
BASELINE (1990)	73.519	L&T IN CB @ NE COR ROSECRANS AVE & OCEAN GATE AVE 40FT N & 40FT E/O C/L INT (4FT E/O BCR)	DY 10167
BASELINE (1990)	93.377	L&BN IN S CB ROSECRANS AVE 42FT S & 70FT W/O C/L INT ROSECRANS AVE & APOLLO ST	DY 10168
BASELINE (1990)	84.558	L&BRAD IN CB @ SW COR SEPULVEDA BLVD & HICKORY AVE 38FT S & 60FT W/O C/L INT (4FT W/O BCR)	DY 10175
BASELINE (1990)	83.765	L&T IN CB @ SW COR SEPULVEDA BLVD & ERIEL AVE 38FT S & 55FT W/O C/L INT (1FT W/O BCR)	DY 10176
BASELINE (1990)	78.486	L&T IN CB @ SW COR SEPULVEDA BLVD & CRENSHAW BLVD 46FT S/O C/L SEPULVEDA BLVD & 74FT W/O C/L CRENSHAW BLVD (0.5FT E/O BCR)	DY 10177
BASELINE (1990)	86.897	RDBM TAG IN CB @ NE COR CRENSHAW BLVD & TORRANCE BLVD 87FT N & 46FT E/O C/L INT (1FT N/O BCR)	DY 10178
BASELINE (1990)	86.373	L&SPK IN SE COR C B @ NW COR CRENSHAW BLVD & TORRANCE BLVD 40FT N & 88FT W/O C/L INT (6FT W/O BCR)	DY 10179
BASELINE (1990)	75.721	RDBM TAG IN CB @ SE COR CRENSHAW BLVD & DOMINGUEZ ST 95FT E & 20FT S/O C/L INT (1FT E/O BCR)	DY 10180
BASELINE (1990)	61.034	RDBM TAG IN CB @ SW COR CRENSHAW BLVD & 182ND ST 55FT S & 38FT W/O C/L INT (1FT S/O BCR)	DY 10181
BASELINE (1990)	60.687	RDBM TAG IN CB @ NW COR CRENSHAW BLVD & 182ND ST 54FT N & 38FT W/O C/L INT (1FT S/O BCR)	DY 10182
BASELINE (1990)	42.089	RDBM TAG IN CB @ SE COR CRENSHAW BLVD & REDONDO BEACH BLVD 61FT S & 40FT E/O C/L INT (1FT S/O BCR)	DY 10183
BASELINE (1990)	42.462	RDBM TAG IN CB @ NE COR CRENSHAW BLVD & REDONDO BEACH BLVD 78FT N & 35FT E/O C/L INT (9FT S/O BCR)	DY 10184

QUAD-YEAR	ELEV	DESCRIPTION (INCLUDE QUAD AND YEAR IN DESCRIPTION)	BM NUMBER
BASELINE (1990)	49.054	RDBM TAG IN CB @ NW COR CRENSHAW BLVD & EL SEGUNDO BLVD 70FT N & 42FT W/O C/L INT (1FT S/O BCR)	DY 10185
BASELINE (1990)	52.752	RDBM TAG IN CB @ NW COR CRENSHAW BLVD & NORTHROP AVE 63FT N & 42FT W/O C/L INT (1FT S/O BCR)	DY 10186
BASELINE (1990)	78.439	L&BRAD IN CB @ NE COR CRENSHAW BLVD & IMPERIAL HWY 56FT N & 44FT E/O C/L INT (18FT S/O BCR)	DY 10187
BASELINE (1990)	194.666	RDBM TAG IN CB @ NE COR CRENSHAW BLVD & HARDY ST 40 FT N & 42FT E/O C/L INT (1FT N/O BCR)	DY 10188
BASELINE (1990)	206.028	RDBM TAG IN CB @ SE COR CRENSHAW BLVD & ARBOR VITAE ST 32FT S & 42FT E/O C/L INT (1FT S/O BCR)	DY 10189
BASELINE (1990)	214.146	CITY OF INGLEWOOD TAG IN CB RET @ SW COR CRENSHAW BLVD & 90TH ST (TO THE WEST) 35FT S & 81FT W/O C/L INT (17FT E/O BCR)	DY 10190
TORRANCE (1990)	54.082	L&SPK IN CONC CB 45FT S & 31FT E/O INT ESPLANADE & AVE D (14FT S/O BCR @ SE COR)	DY 10260
TORRANCE (1990)	54.046	CS MON IN WELL 8IN DN @ C/L INT ESPLANADE & AVE D	DY 10261
TORRANCE (1990)	56.410	DPW BM TAG IN CONC CB @ NE COR ESPLANADE & SAPPHIRE ST 35FT N & 25FT E/O C/L INT (5FT N/O BCR @ SW COR)	DY 10262
TORRANCE (1990)	108.190	DPW BM TAG IN CONC CB @ SW COR TORRANCE BLVD & HAWTHORNE BLVD 84FT W & 57 FT S/O C/L INT (3FT W/O BCR)	DY 10263
TORRANCE (1990)	107.215	DPW BM TAG IN CONC CB @ SE COR TORRANCE BLVD & HAWTHORNE BLVD 104FT E & 44FT S/O C/L INT (5FT E/O BCR)	DY 10264
BASELINE (1990)	71.378	L&T CONC PVMT 9FT S/O C/L ROSECRANS AVE 10FT W/O FIRMONA AVE (TO THE SOUTH)	DY 10265
TORRANCE (1990)	40.686	L&T CONC CB 72FT E/O C/L CATALINA AVE & 28FT S/O C/L CARNELIAN ST (2FT E/O BCR)	DY 10266
TORRANCE (1990)	39.717	DPW BM TAG CB 70FT E/O C/L CATALINA AVE & 28FT N/O C/L CARNELIAN ST (1FT E/O BCR)	DY 10267
TORRANCE (1990)	17.488	DPW BM TAG @ NE COR 28FT E/O C/L HARBOR DR & 13FT N/O BC PACIFIC AVE (2FT N/O BCR)	DY 10268

QUAD-YEAR	ELEV	DESCRIPTION (INCLUDE QUAD AND YEAR IN DESCRIPTION)	BM NUMBER
TORRANCE (1990)	17.471	DPW BM TAG 5FT W/O C/L PROD HARBOR DR (26FT W/O C/L OF CURVE HARBOR DR & 43FT S/O BC OF PACIFIC AVE)	DY 10269
TORRANCE (1990)	13.543	L&BRAD @ SW COR HARBOR DR & PORTOFINO WAY 48FT S & 30FT W/O C/L INT (2FT S/O BCR)	DY 10270
TORRANCE (1990)	13.225	L&BRAD NW COR HARBOR DR & PORTOFINO WAY 36FT W & 34FT N/O C/L INT (CTR CB RET)	DY 10271
TORRANCE (1990)	13.488	L&BRAD W CB TRAFFIC ISLAND PIER AVE 58FT W & 3FT N/O C/L INT HERMOSA AVE & PIER AVE (1FT W/O BCR)	DY 10272
TORRANCE (1990)	23.304	DPW BM TAG E CB OF ISLAND HERMOSA AVE & TWENTYFIFTH ST 42FT N & 3FT E/O C/L INT	DY 10273
TORRANCE (1990)	24.939	DPW BM TAG IN TOP CONC CB 16FT N & 7FT E/O C/L THE STRAND & FIRST ST (4FT W/O C B)	DY 10274
TORRANCE (1990)	34.024	DPW BM TAG IN W CB 13FT W & 5FT N/O C/L INT OCEAN DR & 6TH ST (WALK-WAY)	DY 10275
TORRANCE (1990)	31.492	LAFC 2IN BR CAP MON IN WALK 50FT N & 6FT W/O C/L THE STRAND & 28TH ST	DY 10276
HAWTHRNE (1990)	98.179	DPW BM TAG IN W CB @ SW COR HIGHLAND AVE & 45TH ST 11FT S & 25FT W/O C/L INT (4FT S/O BCR)	DY 10277
HAWTHRNE (1990)	97.795	L&BRAD IN E CB @ NE COR HIGHLAND AVE & 45FT ST 14FT N & 23FT E/O C/L INT (1FT N/O BCR)	DY 10278
HAWTHRNE (1990)	89.611	DPW BM TAG IN E CB OF SECOND EMERGENCY PARKING TURNOUT 22FT E/O VISTA DEL MAR & 0.4MI N/O 45TH ST (1FT N/O BCR)	DY 10279
HAWTHRNE (1990)	36.276	DPW BM TAG IN CONC CB @ DR ENT TO DWP GENERATING STATION 40FT E/O C/L VISTA DEL MAR & .25MI N/O GRAND AVE (1FT S/O BCR)	DY 10280
HAWTHRNE (1990)	37.818	DPW BM TAG IN N CB OF HYPERION TREATMENT PLANT 62FT E/O C/L VISTA DEL MAR & 0.55MI N/O INT GRAND AVE (VISITORS PARKING LOT EXIT DRIVE)	DY 10281
HAWTHRNE (1990)	47.379	SPK&W IN W CB VISTA DEL MAR 112FT S & 28FT W/O INT VISTA DEL MAR & KILLGORE ST	DY 10282
HAWTHRNE (1990)	55.457	L&SPK @ SE COR VISTA DEL MAR & DEAUVILLE ST 62FT S & 28FT E/O C/L INT (1FT S/O BCR)	DY 10283
HAWTHRNE (1990)	54.280	L&SPK IN E CB @ NE COR VISTA DEL MAR & CENTURY BLVD 64FT N & 24FT E/O C/L INT (1FT N/O BCR)	DY 10284

QUAD-YEAR	ELEV	DESCRIPTION (INCLUDE QUAD AND YEAR IN DESCRIPTION)	BM NUMBER
HAWTHRNE (1990)	49.416	L&BRAD W CB VISTA DEL MAR & GILLIS ST 28FT W & 25FT N/O C/L INT (C/L PROD OF GILLIS ST)	DY 10285
HAWTHRNE (1990)	6.050	L&BRAD N CB ISLAND ON S SIDE CULVER BLVD & NICHOLSON ST 40FT E & 36FT S/O C/L INT	DY 10286
HAWTHRNE (1990)	5.529	LACE 1 1/2IN BRASS DISK IN TOP HDWL 74 FT E/O C/L JEFFERSON BLVD & 58FT N/O C/L CULVER BLVD MKD (PBM 17-02311-1979)	DY 10287
HAWTHRNE (1990)	13.898	DPW BM TAG IN N CB JEFFERSON BLVD 1FT E/O BCR @ NE COR JEFFERSON BLVD & WESTLAWN AVE 43FT N & 66FT E/O C/L INT	DY 10288
HAWTHRNE (1990)	17.898	L&SPK IN S CB CENTINELA AVE @ SW COR CENTINELA AVE & TEALE ST 47FT S & 45FT W/O C/L INT (1FT W/O BCR)	DY 10289
HAWTHRNE (1990)	18.136	L&SPK IN S CB CENTINELA AVE @ SE COR CENTINELA AVE & TEALE ST 54FT S & 90FT E/O C/L INT (E END OF C B)	DY 10290